

The logo for Melvyn Danes Estate Agents is a yellow oval with a green border. The word "Danes" is written in a large, bold, green sans-serif font. Above it, "melvyn" is written in a smaller, lowercase green font. Below "Danes", the words "ESTATE AGENTS" are written in a smaller, uppercase green font.

melvyn
Danes
ESTATE AGENTS

A two-story semi-detached house with a dark grey tiled roof and a brick chimney. The house features a mix of brickwork and cream-colored render. It has two large bay windows with white frames and diamond-patterned glass. The front door is black with a white arched surround. A paved path leads to the door, and a green lawn is visible in the foreground.

Whitecroft Road

Sheldon

Offers Around £295,000

Description

A beautifully presented, extended semi detached house on a popular road in Sheldon with a SUPERB EXTENDED KITCHEN/DINER!

This lovely property is ready to move into and is in a great location near to a good range of facilities, shops and schools.

Comprising entrance hall, lounge, study and an impressive kitchen/diner with bi fold doors leading onto the paved patio area to the ground floor. Upstairs there are three good sized bedrooms and the bathroom.

Further benefiting from central heating, double glazing, off road parking for two cars to the front, rear garage with a further parking space and a pleasant rear garden.



Accommodation

Driveway

Enclosed Porch

Entrance Hall

2'11 min x 17'2 (0.89m min x 5.23m)

Lounge

12'5 x 13'4 into bay (3.78m x 4.06m into bay)

Study

7'11 x 10'3 (2.41m x 3.12m)

Extended Re Fitted Kitchen

17'6 max x 18'3 (5.33m max x 5.56m)

Utility Area

3'5 x 12'6 (1.04m x 3.81m)

Landing

Bedroom One

11'7 x 9'6 to bay (3.53m x 2.90m to bay)

Bedroom Two

10'2 x 9'7 (3.10m x 2.92m)

Bedroom Three

7'11 x 9'2 (2.41m x 2.79m)

Bathroom

4'4 x 10'2 (1.32m x 3.10m)

Rear Garden

Rear Garage

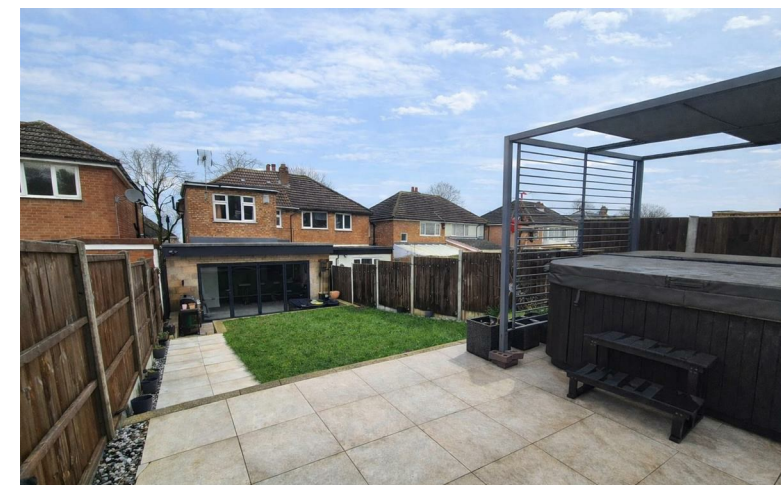

TENURE: We are advised that the property is Freehold.

These particulars are for general guidance only and are based on information supplied and approved by the seller. Complete accuracy cannot be guaranteed and may be subject to errors and/or omissions. They do not constitute representations of fact or form part of any offer or contract. Any Prospective Purchaser should obtain verification of all legal and factual matters and information from their Solicitor, Licensed Conveyancer or Surveyors as appropriate. The agent has not sought to verify the legal title of the property and the buyers must obtain verification from their solicitor. Photographs are provided for illustrative purposes only and the items shown in these are not necessarily included in the sale, unless specifically stated. The agent has not tested any apparatus, equipment, fixtures, fittings or services mentioned and do not by these Particulars or otherwise verify or warrant that they are in working order.

BROADBAND/MOBILE: Please refer to checker www.ofcom.gov.uk for broadband and mobile coverage at the property. From data taken on 10/02/2026 we understand that the standard broadband download speed at the property is around 15 Mbps, and the estimated fastest download speed currently achievable for the property post code area is around 1800 Mbps. Actual service availability or speeds received may be different and may vary depending on the time a speed test is carried out. Mobile coverage can vary depending on the network provider and other factors that can affect the local mobile reception and actual services available may be different depending on the particular circumstances, precise location and network outages.

MONEY LAUNDERING REGULATIONS: Under anti-money laundering legislation, we are obliged to confirm the identity of individuals and companies and the beneficial owners of organisations and trusts before accepting new instructions, and to review this from time to time. To avoid the need to request detailed identity information from vendors and intending purchasers, we may use approved external services which review publicly available information on companies and individuals. However, should those checks, for any reason, fail adequately to confirm identity, we may write to you to ask for identification evidence. If you do not provide satisfactory evidence or information within a reasonable time, we may have to stop acting for you and we would ask for your co-operation in order that there will be no delay in agreeing a sale. Any purchaser who has a provisional offer accepted via this company will be liable to pay an administration fee of £25 (incl VAT) for each person connected with the transaction to cover these checks. If we are instructed by a third party selling agent they may carry out their own AML checks and any prospective purchaser will be required to pay any additional costs involved – please speak to the office for confirmation.

REFERRAL FEES: We may refer you to recommended providers of ancillary services such as Conveyancing, Financial Services and Surveying. We may receive a commission payment fee or other benefit (known as a referral fee) for recommending their services. You are not under any obligation to use the services of the recommended provider.

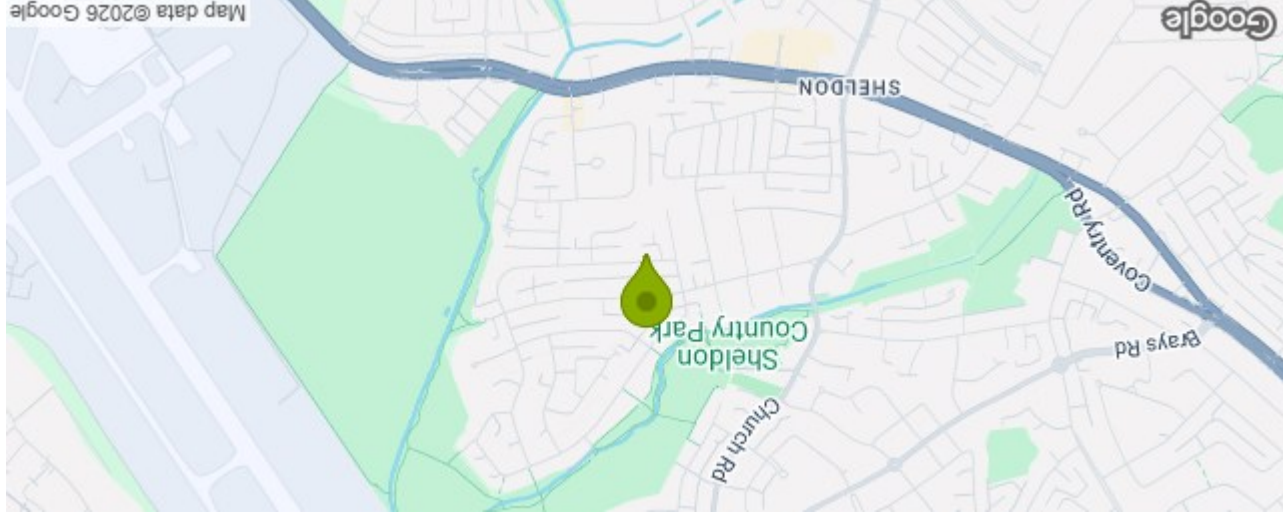

Energy Efficiency Rating	
Potential	79
Current	69
Very energy efficient - lower running costs	
A	(92 plus)
B	(81-91)
C	(69-80)
D	(55-68)
E	(39-54)
F	(21-38)
G	(1-20)
Not energy efficient - higher running costs	
EU Directive 2002/91/EC	
England & Wales	

21 Whitecroft Road Sheldon Birmingham B26 3RD
Council Tax Band: C

Total area: approx. 100.8 sq. metres (1085.3 sq. feet)

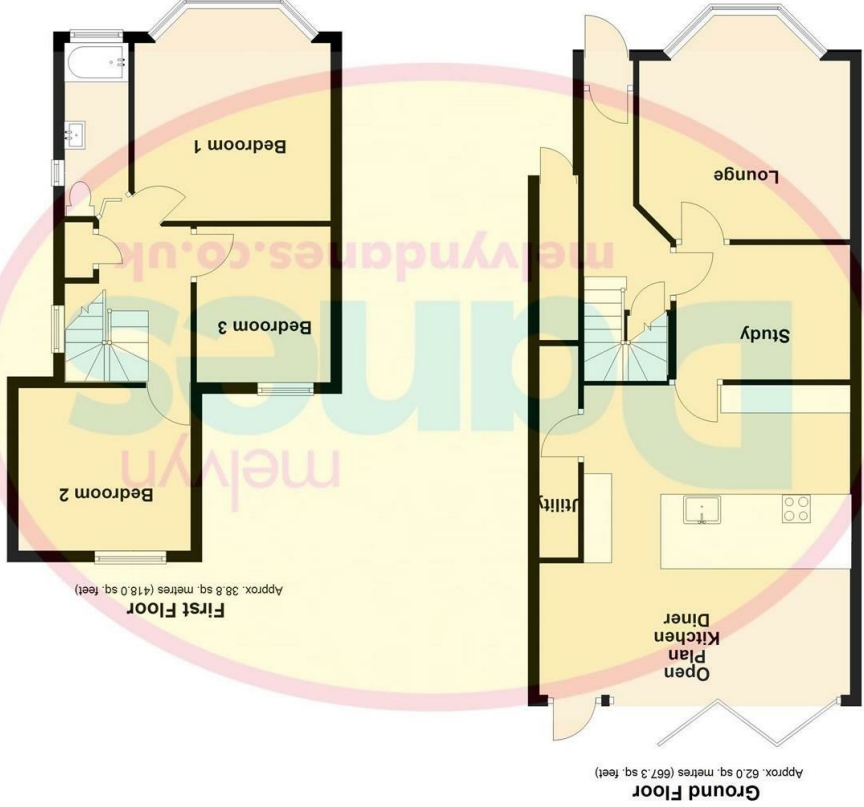

Approx. 38.8 sq. metres (418.0 sq. feet)

Approx. 62.0 sq. metres (667.3 sq. feet)

Please note that all measurements and floor plans are approximate and quoted for general guidance only and whilst every attempt has been made to ensure accuracy, they must not be relied on and do not form part of any contract.